

GIUNTI WATERSTOP:

Sono profilati in PVC utilizzati per realizzare giunti di ripresa e di dilatazione nei getti di cemento armato.

Assicurano una perfetta tenuta idraulica delle strutture (canalizzazioni, serbatoi, dighe, depuratori, ecc.) e sono dimensionati per resistere alle sollecitazioni dell'assestamento delle strutture e per adeguarsi alle escursioni termiche.

Possano essere realizzati anche in gomma.

SERIE NORMALE

WLA

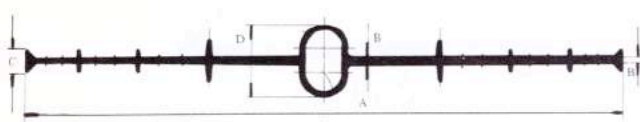

ARTICOLO	A	B	C	D
WLA 100	100	2÷3	8	21
WLA 150	150	2÷2,5	10	26
WLA 200	200	2,5÷3,5	11	30
WLA 250	250	2,5÷3,5	11	30
WLA 300	300	3÷4	11	30

WLB

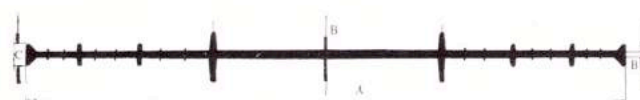

ARTICOLO	A	B	C	D
WLB 100	100	2÷3	8	
WLB 150	150	2÷2,5	10	
WLB 200	200	2,5÷3	10	
WLB 250	250	2,5÷3,5	11	
WLB 300	300	3÷4	11	

WPE

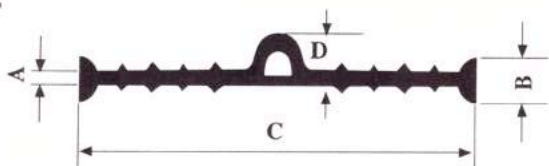

ARTICOLO	A	B	C	D
WPE 150	3	14	150	18
WPE 151	5÷6	20	150	18
WPE 225	6÷6,5	20	225	18

WPF

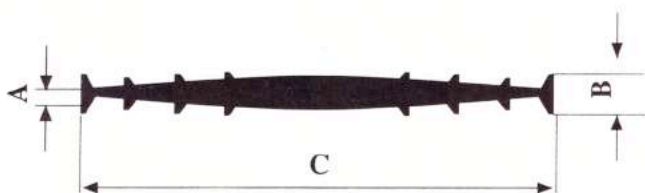

ARTICOLO	A	B	C
WPF 150	3÷4,5	15	150
WPF 151	6,4	12	150
WPF 200	4,5÷6,5	15	200
WPF 201	5÷16	17	200
WPF 285	5÷7	15	285
WPF 286	5÷16	17	285

WPG

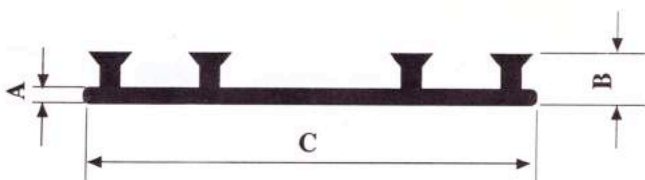

ARTICOLO	A	B	C
WPG 150	4	20	150
WPG 200	4	20	200
WPG 240	4	20	240
WPG 320	4	22	320

WPH

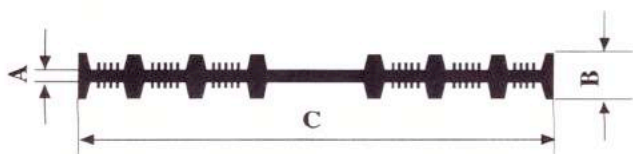

ARTICOLO	A	B	C
WPH 150	3	12	150
WPH 200	4	10	200
WPH 250	4÷6	10	250
WPH 300	5	11	300

WPL

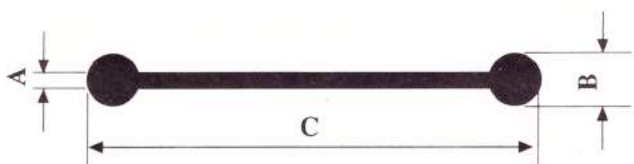

ARTICOLO	A	B	C
WPL 100	5	12	100
WPL 150	5	14	150
WPL 151	10	20	150
WPL 200	5	14	200
WPL 230	5	19	230
WPL 231	10	23	230
WPL 400	20	40	400

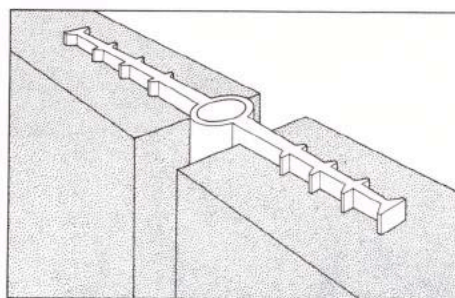
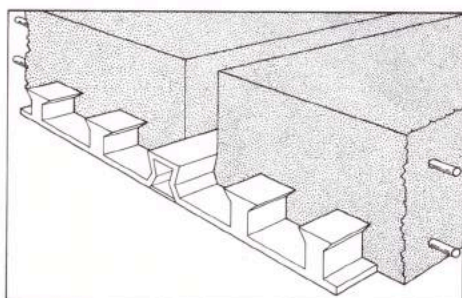

• LAMA RISCALDANTE COMPLETA DI PARTE ELETTRICA Largh. 400

• LAMA RISCALDANTE COMPLETA DI PARTE ELETTRICA Largh. 520

WPA

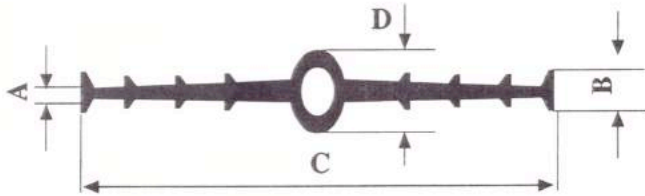

ARTICOLO	A	B	C	D
WPA 140	3	13	140	30
WPA 145	2,5÷3,5	16	145	30
WPA 150	2,5	13	150	32
WPA 151	7	20	150	37
WPA 170	3	13	170	30
WPA 180	3÷6	16	180	33
WPA 200	3,5÷5	15	200	30
WPA 221	2,5÷4	9	220	36
WPA 220	3÷6	15	220	35
WPA 240	3÷6	16	240	30
WPA 250	4	14	250	37
WPA 300	3,5	14	300	37
WPA 301	5	15	300	40
WPA 360	5,5÷7,5	24	360	50
WPA 361	7÷9	20	360	50
WPA 375	8÷15	25	375	50
WPA 400	5÷8	21	400	50
WPA 440	5÷8	21	400	50

WPB

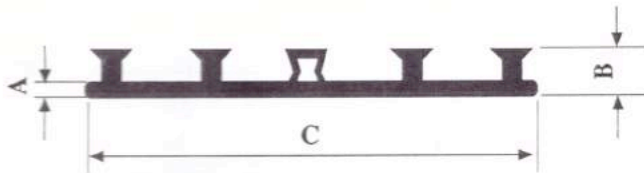

ARTICOLO	A	B	C
WPB 150	7	40	150
WPB 200	4	18	200
WPB 230	4	18	230
WPB 240	4	18	240
WPB 275	5	20	275
WPB 320	4	21	320
WPB 360	7÷9	35	360

WPC

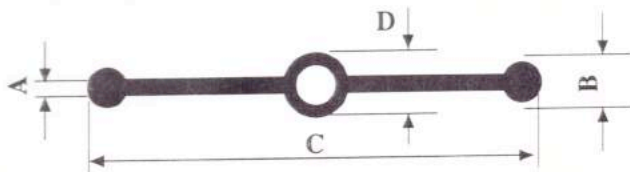

ARTICOLO	A	B	C	D
WPC 100	4,5÷6,5	13	100	22
WPC 150	5	15	150	18
WPC 151	10	20	150	30
WPC 200	5	15	200	18
WPC 210	10	24	210	35
WPC 230	5	17	230	22
WPC 231	10	23	230	33
WPC 240	5	19	240	27
WPC 300	10	26	300	35

WPD

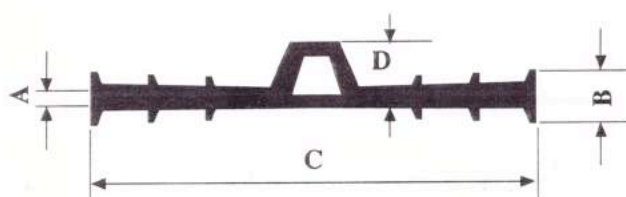

ARTICOLO	A	B	C	D
WPD 250	7÷9	27	250	35
WPD 310	5÷6	16	310	75
WPD 320	5	25	320	30
WPD 321	7÷10	24	320	35
WPD 340	5÷10	14	340	50
WPD 360	5÷7	23	360	80
WPD 400	5÷6	21	400	48
WPD 520	4÷8	25	520	48